



5000 series Eclipse range Hands Free Intercoms & Video Monitors



5000 series Eclipse range

Hands Free Intercoms & Video Monitors



The recently introduced **5000 series** range of hands free (simplex or voice switched depending upon model) audio and video monitors can be identified by their slim and compact design, allowing the 5000 series units to be used in areas where space is limited.

The hands free voice switching technology delivers excellent audio quality and efficient noise cancellation (larsen effect). The choice of manufacturing technology has resulted in the slim and compact design.

The Eclipse range has "answer/recall", "door open" and "privacy on-off" (which is user programmable) buttons common to all products (except Art.5112 where the privacy service is activated by a switch), service push buttons will vary from model to model (audio intercom or video monitor) but will have a minimum of one. Led's are also provided to give visual indication of functions and system operation.

All Eclipse audio and video units are supplied surface mounting as standard. An optional telephone handset kit is available for the surface mount version of the Eclipse video monitor. A flush mounting kit is also available for the Eclipse video monitor (no handset kit available when flush mounted). The simplex version (Art.5412) of the Eclipse video monitor is supplied complete with a telephone handset as standard.

The installation of the surface or flush audio or video monitors is carried out by attaching the flat ribbon cable on the front panel to the pcb connector board which is housed in the wall fixing plate, once all cables have been terminated into the pcb connector board the ribbon cable can be connected and the front plate can then be securely clipped onto the wall fixing plate.

The Eclipse video monitor is only available with a colour 3.5" active matrix LCD display. Standard controls include call tone volume (some versions include a choice of call tone melody), speech loudspeaker volume and brightness and hue controls.

In addition to the standard polar white finish, the Eclipse range of audio and video monitors in surface, flush and including optional handset kits are available in two additional colours.

- Carbon Fibre effect (add "/CA" to the product code when ordering).
- Silver (add "/CR" to the product code when ordering).

Videx have further expanded the 5000 Eclipse range with the introduction of the Art.5188 (eclipse hands free intercom for the VX2300 digital system) and two eclipse SLIM Line versions for use on the VX2200 (SL5478) and VX2300 (SL5488) digital systems. Both SLIM Line versions are designed for surface mounting and have a maximum body depth of only 34.5mm compared to 52mm for the standard eclipse. For harsher environmental applications, Videx have introduced a Vandal Resistant hands free video monitor (Art.VR5478) and a Vandal Resistant hands free intercom (Art.VR5178) both for use on the popular VX2200 digital system. These units are manufactured with brushed 2.5mm stainless steel face plate and are designed for flush mounting only. The above functions and controls as indicated above may vary and will depend on the system used.

Intercoms in the 5000 series audio Eclipse range are identified by the compact design and "hands free" function which can be user selected between simplex or voice switched.

All intercoms in the 5000 series Eclipse range have 4 (3 in the vandal resistant version) function buttons, these include "answer", "door open" and "service" which are common to all models while the fourth button's operation will vary from model to model.

The "privacy" (no calls) and call tone volume controls are standard to all versions. Selected versions also incorporate loudspeaker volume control.

For harsher environmental applications Videx have introduced a "vandal resistant" model Art. VR5178 for use on the popular VX2200 digital system.

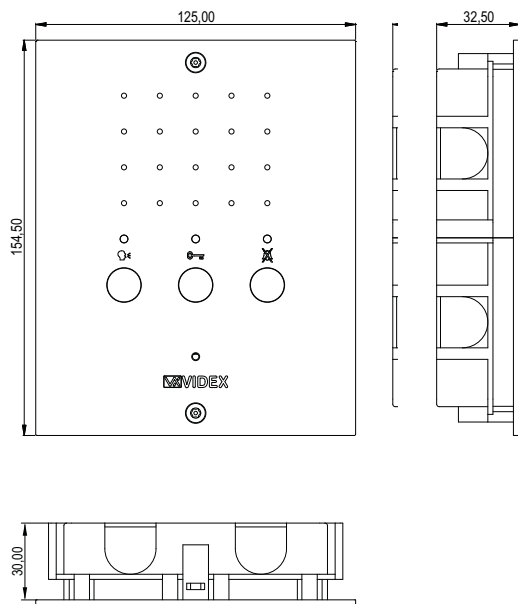
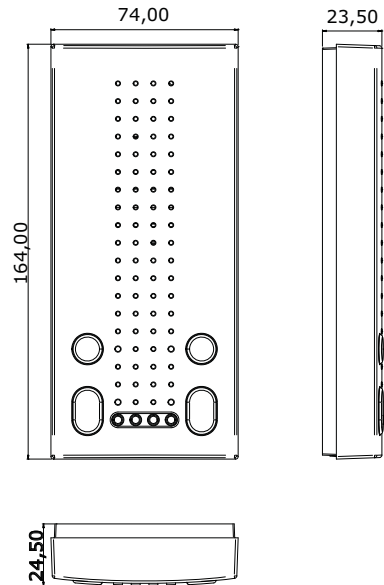
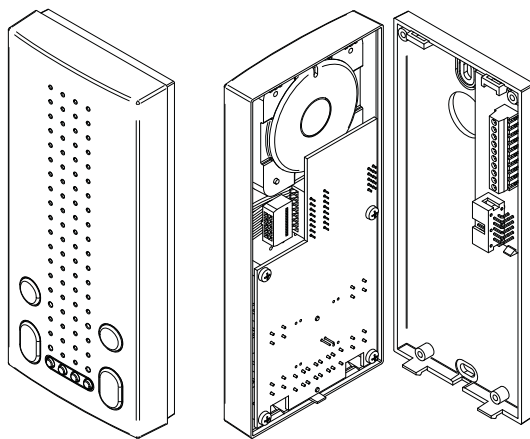

5000 series Eclipse range

Hands Free Intercoms



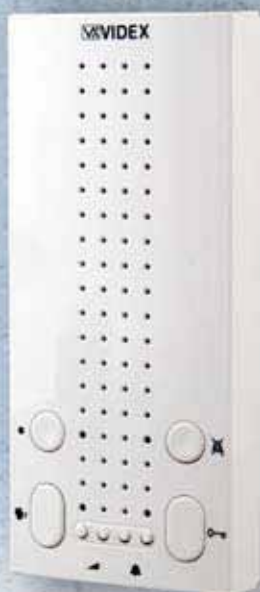

Art.5118
Art.5178
Art.5188

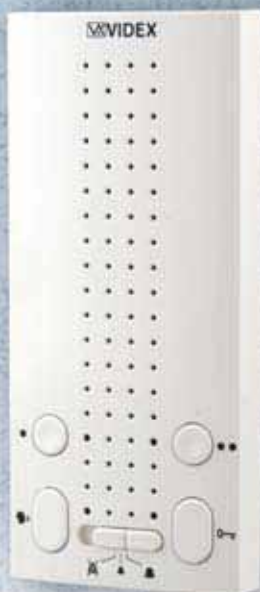

Art.5112

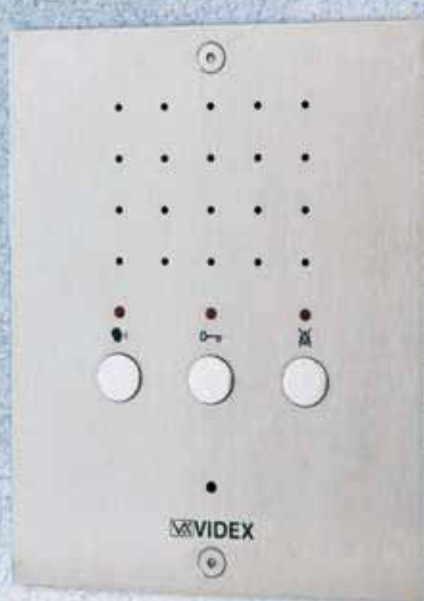

VR5178

Vandal Resistant line

Art. HANDS FREE INTERCOMS FOR "4+1" AUDIO DOOR ENTRY SYSTEMS

5112 Simplex intercom with buttons to control "answer" (press to talk/release to listen), "door open" and 2 service buttons. 3 LEDs to confirm the talk/listen status, the open/close door status and the on/off status of the privacy (no calls). A 3 position call tone volume switch which when in the left position will enable the privacy function (no calls), in the centre position low volume and in the right position high volume.

5118 Voice switched hands free intercom with buttons to control "answer/end conversation", "door open", "privacy on/off" and "service" button. In addition there are 4 LEDs to indicate the status of "answer/end conversation", "door open/closed", "privacy on/off" and auxiliary "service" status. Call tone and loudspeaker volume controls are also incorporated on this model.

Art. HANDS FREE INTERCOMS FOR VX2200 DIGITAL SYSTEM

5178 Voice switched hands free intercom with buttons to control "answer/end conversation/recall/simplex conversation", "door open", "privacy on/off" (programmable duration) and "service" button. In addition there are 4 LEDs* to indicate the status of "answer/end conversation", "door open/closed", "privacy on/off" and auxiliary "service" status. Call tone and loudspeaker volume controls, through assigned buttons, are also incorporated on this model. It is possible to program the melody (9 available), the number of rings (max 9) and the privacy service duration (max 20 hours). Surface wall mount installation.

VR5178 Same features of Art.5178 but vandal resistant version: the "service" button that is missing, is replaced by the "privacy" button that works also as "service" button. Adjustments and programmable functions are the same but are carried out in a different way. Vandal resistant version is for flush mount. This version is made from a brushed 2.5mm stainless steel plate. The intercom includes the flush mounting box with security fixings.

Art. HANDS FREE INTERCOMS FOR VX2300 DIGITAL SYSTEM

5188 Voice switched hands free intercom with buttons to control "answer/end conversation/recall/simplex conversation", "door open/intercommunicating call", "privacy on/off" (programmable duration) and "BUS relay control" (Art.2305) button. In addition there are 4 LEDs* to indicate the status of "answer/end conversation", "door open/closed", "privacy on/off" and programming status. Call tone and loudspeaker volume controls, through assigned buttons, are also incorporated on this model. In addition to programming required from the VX2300 digital system (address, extension address and intercommunication mode) it is possible to program the melody, the number of rings and the privacy service duration. Surface wall mount installation.

* The operation of some LED's may depend on the cabling, the operation described is referred to a specific and correct cabling.

5000 series Eclipse range

Hands Free Intercoms



Art.5118/CA
Art.5178/CA
Art.5188/CA



Art.5118/CR
Art.5178/CR
Art.5188/CR

5000 SERIES HANDS FREE INTERCOMS FINISHES

In addition to standard white finish, Eclipse line intercoms are available in 2 additional finishes:

- Carbon Fibre effect (add to the product code "/CA" when ordering)
- Silver Painting (add to the product code "/CR" when ordering)



Art. CR044W



Art. CR044G

DECORATIVE WALL PLATES

Decorative wall plates for 5000 Series ECLIPSE line hands free intercoms. Are available in two finishes: white CR044W and grey CR044G. The decorative wall plates do not require any fixing screws as the body of the intercom will secure the decorative plate when it is secured to its wall bracket / mounting plate.

Videomonitors from the 5000 Series Eclipse can be identified by the new compact design, high quality 3.5" TFT Lcd colour display and "hands free" function with simplex or voice switched operation (depending on model), all 5000 Series Eclipse with the exception of the Art.5488 will operate using coax or balanced video signals.

All models in the 5000 Series Eclipse range have 6 function buttons of which "door open", "answer/recall" and "privacy" are common to all models, the remaining buttons will vary from model to model. All models have 8 control buttons of which 4 are reserved to adjust "brightness" and "hue" and the remaining buttons to adjust loudspeaker volume, call tone volume and to select the melody or adjust the melody volume depending on the model. Eclipse monitors are supplied without handsets and are surface mounting as standard (except Art.5412 which incorporates a handset as standard). Flush mounting kits and handset kits (except when flush mounted) are available when or where required.

The SLIM line low profile eclipse has the same button layout with the same functions as the standard eclipse, all SLIM line eclipse models are designed for surface mounting only and have a maximum depth of 34.5mm. The SLIM line eclipse has not been designed to accept the addition of a telephone handset. Two versions are currently available Art.SL5478 for use with the VX2200 digital system and Art.SL5488 for use with the VX2300 digital system. The wall mounting plate for the SLIM line is attached to the wall and cables are then terminated to the PCB terminals, when this is completed the ribbon cable on the main body of the SLIM line is attached to the wall plate socket PCB connector board and the body of the SLIM line monitor is then attached to the wall plate.

The Vandal Resistant eclipse (Art.VR5478) is only available for use on the VX2200 digital system and has been designed for flush fitting only. The face plate of the VR5478 is manufactured in 2.5mm brushed stainless steel. The programming of the variable (volume level, call tone level, contrast, hue and privacy time) functions are carried out using OSD menu (On Screen Display) technology.

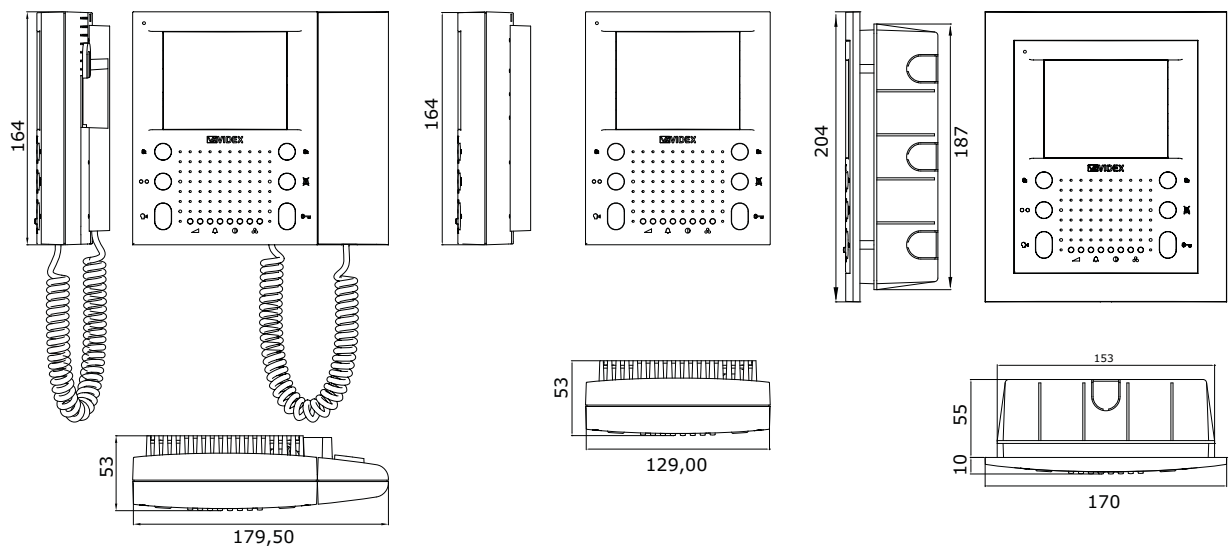

5000 series Eclipse range

Hands Free Video Monitor





Art.5418
Art.5478
Art.5488



Art.5412
Art.5418+5982
Art.5478+5982
Art.5488+5982



Art.5418+5981
Art.5478+5981
Art.5488+5981

Art. VIDEO MONITORS FOR TRADITIONAL VIDEO DOOR ENTRY SYSTEMS USING COAX OR BALANCED VIDEO SIGNAL

5412 Videophone complete with handset using 3,5" full colour active matrix LCD monitor, with "door open", "answer/camera recall", "privacy on/off" buttons and 3 service buttons (that can be set as auxiliary camera recall buttons for multiple entrance systems) plus 4 LEDs*: 3 relative to the operation of the 3 buttons above and one auxiliary for free use.
Controls: call tone volume, melody, brightness and hue. Programmable melody, number of rings, privacy duration, door opening time and video mode.
Inputs for electronic call tone main and local.

5418 Hands free video monitor using 3,5" full colour active matrix LCD monitor, with "door open", "answer/camera recall", "privacy on/off", "latch relay" buttons all with LED indication and 2 additional service buttons.
Controls: loudspeaker volume, call tone volume, brightness and hue.
Programmable number of rings, privacy duration, door opening time and video mode.
Input for electronic call tone.



34

Art. HANDS FREE VIDEOMONITORS FOR VX2200 DIGITAL SYSTEM USING COAX OR BALANCED VIDEO SIGNAL

5478 Intelligent Hands free video monitor specific for VX2200 digital system using 3,5" full colour active matrix LCD monitor, with "door open", "answer/camera recall", "privacy on/off", "latch relay" buttons all with LED indication and 2 additional service buttons.
Controls: loudspeaker volume, call tone volume, brightness and hue.
Programmable number of rings, privacy duration, door opening time and video mode.
Electronic call tone offered by the system plus active low inputs for local bell and alarm.

Art. HANDS FREE VIDEOMONITORS FOR VX2300 TWO WIRE BUS DIGITAL SYSTEM

5488 Intelligent Hands free video monitor using 3,5" full colour active matrix LCD monitor, with "door open/intercommunicating call", "answer/camera recall", "privacy on/off", "bus relay activation" buttons all with LED indication and 2 additional service buttons.
Controls: loudspeaker volume, call tone volume, brightness and hue.
Programmable number of rings, privacy duration and intercommunication mode.
Electronic call tone plus active low inputs for local bell and alarm.

*The operation of some LEDs may depend on the cabling, the operation described is referred to a specific and correct cabling.

5000 series Eclipse range

Hands Free Video Monitor



Art.SL5478
Art.SL5488



Art.VR5478

Slim line

Vandal Resistant line

Art. HANDS FREE VIDEOMONITORS FOR VX2200 DIGITAL SYSTEM USING COAX OR BALANCED VIDEO SIGNAL

SL5478 Same features of Art.5478 (except a small difference in the programming) but SLIM line version with a depth of 34.5mm. Only for surface mount, optional handset not available, optional decorative frame available.

VR5478 Same features of Art.5478 but VANDAL RESISTANT line version. Programming and adjustments are carried out through a contextual OSD menu. Only for flush mount.

Art. HANDS FREE VIDEOMONITORS FOR VX2300 TWO WIRE BUS DIGITAL SYSTEM

SL5488 Same features of Art.5488 (except a small difference in the programming) but SLIM line version with a depth of 34.5mm. Only for surface mount, optional handset not available, optional decorative frame available.

** The operation of some LEDs may depend on the cabling, the operation described is referred to a specific and correct cabling.*

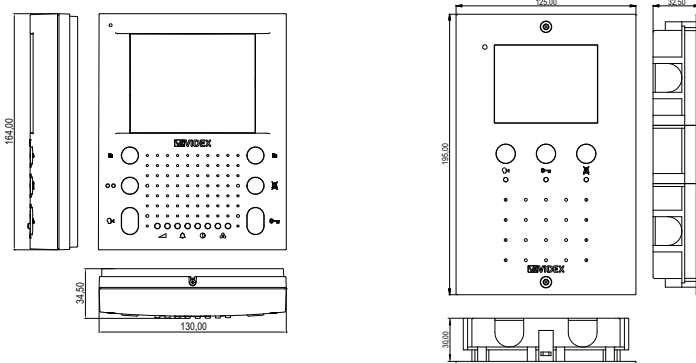
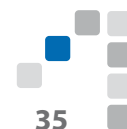

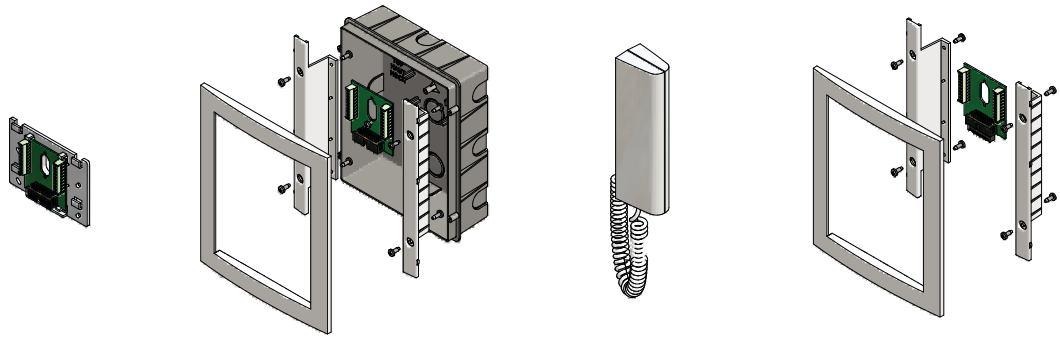

Art.5980

Art.5981

Art.5982

Art.5983

Art. ACCESSORY HANDS FREE VIDEOMONITORS

5980 Mounting plate and pcb connection board for surface eclipse videomonitors. One required to fix a surface eclipse to the wall and make connections.

5981 Flush mounting kit for hands free eclipse videomonitors (except Art.5412) comprised of flush box, fixing brackets, covering frame and pcb connection board.

5982 Handset kit for hands free eclipse videomonitors (except Art.5412). It includes the handset, the cord and the handset bracket.

5983 Flush mounting kit (for dry line walls) for hands free eclipse videomonitors (except Art.5412) comprised of fixing brackets, covering frame and pcb connection board.

NOTE:

The above accessories are not available for the SL series.



Art. CR045G



Art. CR045W

DECORATIVE WALL PLATES

Decorative wall plates for 5000 Series SLIM line hands free video monitors. Are available in two finishes: white CR045W and grey CR045G. The decorative wall plates do not require any fixing screws as the body of the videophone will secure the decorative plate when it is secured to its wall bracket/mounting plate.

5000 series Eclipse range

Hands Free Video Monitor



Art.5418/CA
Art.5478/CA
Art.5488/CA
Art.SL5478/CA
Art.SL5488/CA



Art.5412/CA
Art.5418/CA +5982/CA
Art.5478/CA +5982/CA
Art.5488/CA +5982/CA



Art.5418/CA +5981/CA
Art.5478/CA +5981/CA
Art.5488/CA +5981/CA



Art.5418/CR
Art.5478/CR
Art.5488/CR
Art.SL5478/CR
Art.SL5488/CR



Art.5412/CR
Art.5418/CR +5982/CR
Art.5478/CR +5982/CR
Art.5488/CR +5982/CR



Art.5418/CR +5981/CR
Art.5478/CR +5981/CR
Art.5488/CR +5981/CR



5000 SERIES ECLIPSE LINE HANDS FREE VIDEOMONITORS FINISHES

In addition to standard white finish, Eclipse line videomonitors, flush mounting kit and handset kit are available in two additional finishes:

- Carbon Fibre effect (add to the product code "/CA" when ordering)
- Silver Painting (add to the product code "/CR" when ordering)